



, NW3 2JX

£2,500 Per Month



2



1



1



1 Estelle Road



Description

A very spacious and bright two bedroom apartment in excellent condition throughout with wooden floors on the second floor of a period house enjoying a great location on a quiet street close to Gospel Oak, the Heath and the amenities of South End Green.

The property, which has lovely stripped wooden flooring throughout comprises of a fantastic, bright and very spacious reception room with French doors leading into a spacious and modern dining room/ fitted kitchen, 2 bedrooms and a fully tiled modern bathroom.

Estelle Road is a peaceful location offering easy access to the Overground at Gospel Oak and only a short walk from the Northern Line at Belsize Park. The open spaces of Hampstead Heath, Marks and Spencer and the various restaurants, pubs and cafe's of South End Green are just around the corner. There are excellent local schools and CFBL is within walking distance.

Available 10th November

- Two bedroom period conversion
- Bright and generous reception
- Second Floor
- Council Tax Band E
- Long term let
- Stripped wooden flooring
- Very spacious eat-in kitchen
- In excellent condition
- Deposit of 5 weeks rent





Floor Plan

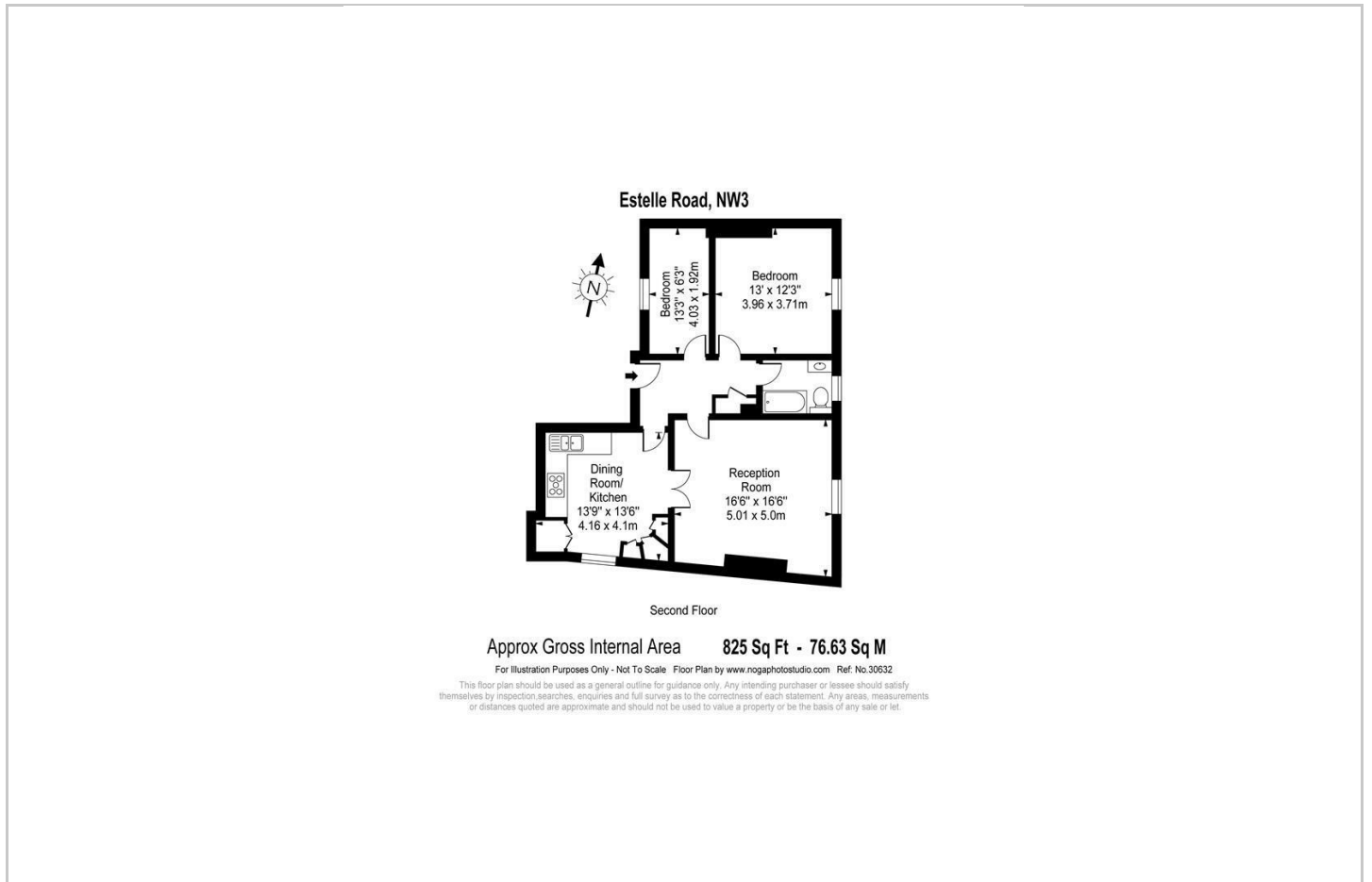

Area Map

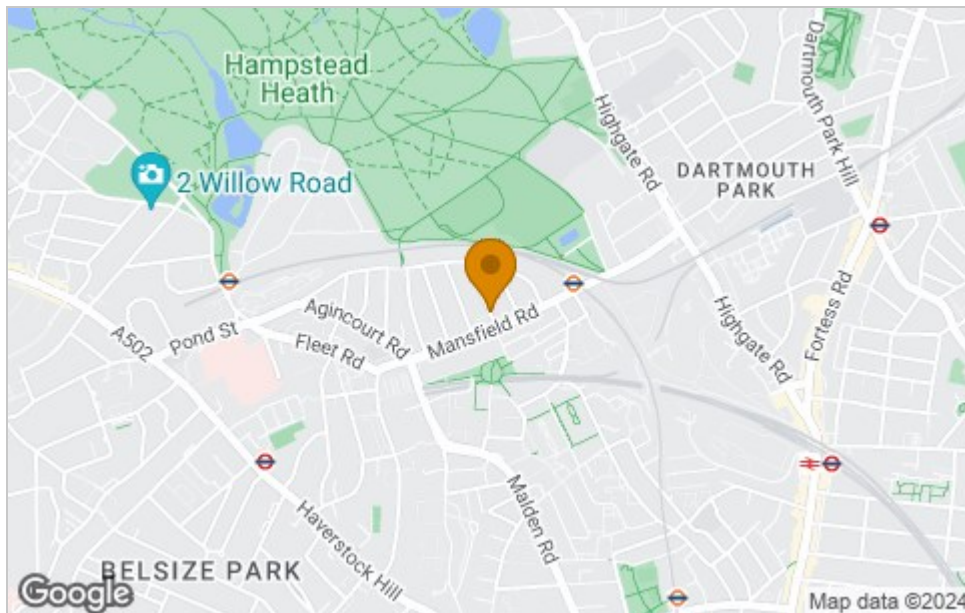

Energy Efficiency Graph

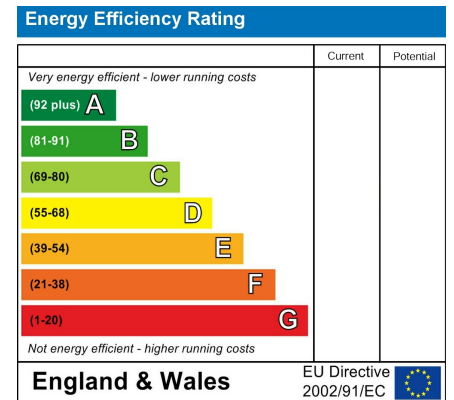

Viewing

Please contact our Hampstead Lettings Office on 020 7431 1881 if you wish to arrange a viewing appointment for this property or require further information.

These particulars, whilst believed to be accurate are set out as a general outline only for guidance and do not constitute any part of an offer or contract. Intending purchasers should not rely on them as statements of representation of fact, but must satisfy themselves by inspection or otherwise as to their accuracy. No person in this firm's employment has the authority to make or give any representation or warranty in respect of the property.

47 South End Road, Hampstead, London, NW3 2QB
 Tel: 020 7431 1881 Email: residential@salter-rex.co.uk salter-rex.co.uk