



Hampstead Heath, London, NW3 2TD

Asking Price £350,000



1



1



1



D

17 South Hill Park Gardens



Description

A bay-fronted studio apartment, set on the raised ground floor of a semi-detached, double-fronted Victorian house, situated moments from Hampstead Heath.

In need of modernisation, the property benefits from a generous sized reception/kitchen with high ceilings and a feature fire place, and separate bathroom/WC.

South Hill Park Gardens is ideally located for access to the Heath and Hampstead Ponds, and only a short walk from the amenities, bars and restaurants of South End Green, and within easy reach of the outstanding array of cultural and culinary attractions and nightlife of both Belsize Park and Hampstead Village. Hampstead Heath Overground Station is less than a 5 minute walk away, and Belsize Park Underground Station (Northern Line Zone 2) approximately 15 minutes' walk, providing excellent transport links to the City, West End and beyond.

Lease: Approx 86 years

- BAY-FRONTED STUDIO APARTMENT
- HIGH CEILINGS
- 5 MINUTES' WALK TO HAMPSTEAD HEATH OVERGROUND STATION
- RAISED GROUND FLOOR
- CLOSE TO HAMPSTEAD HEATH & HAMPSTEAD PONDS
- NO ONWARD CHAIN





Floor Plan

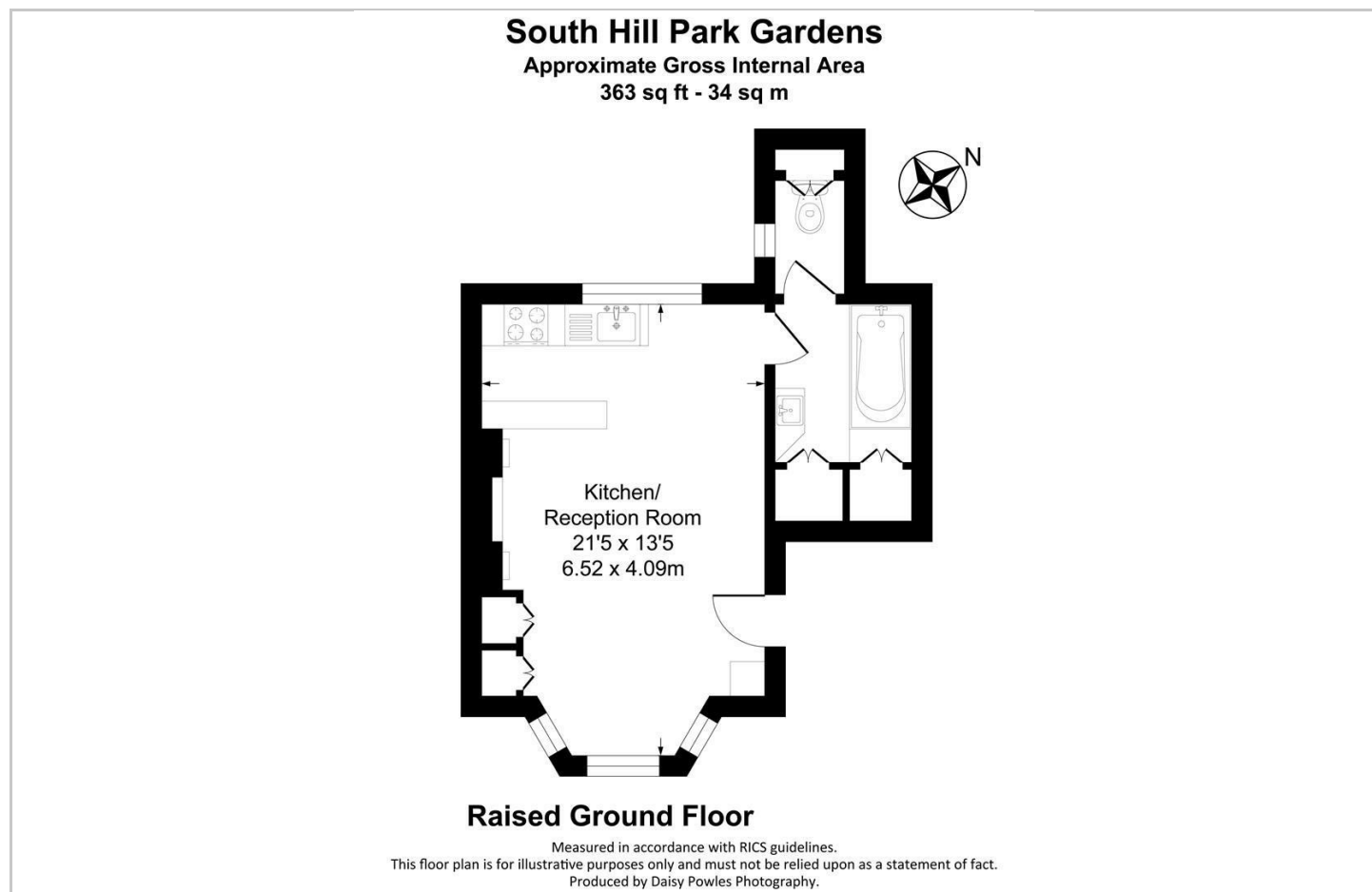

Area Map

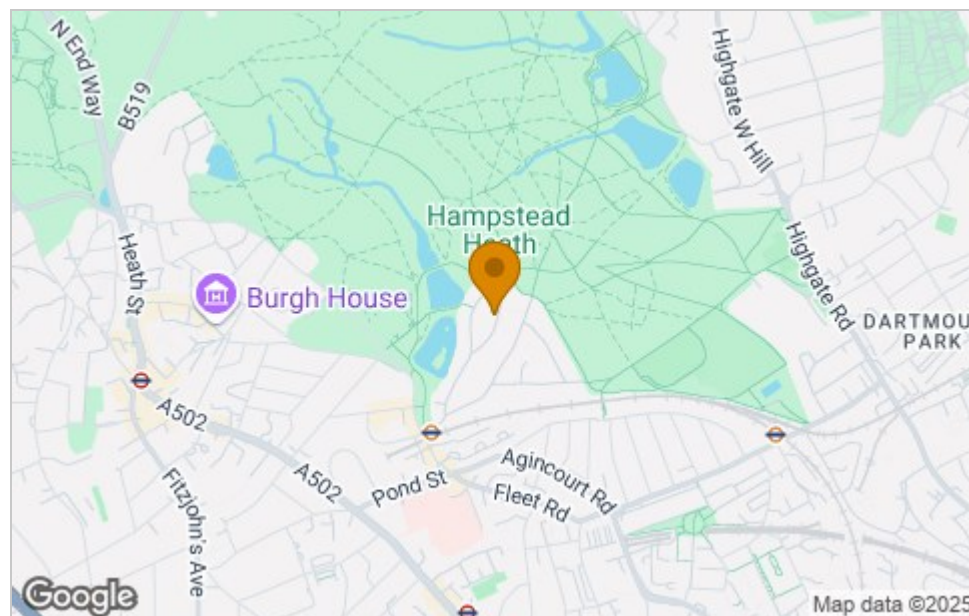

Energy Efficiency Graph

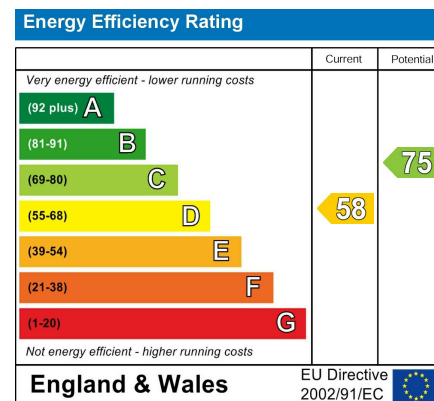

Viewing

Please contact our Hampstead Sales Office
on 020 7431 1881 if you wish to arrange a viewing appointment for this property
or require further information.

These particulars, whilst believed to be accurate are set out as a general outline only for guidance and do not constitute any part of an offer or contract. Intending purchasers should not rely on them as statements of representation of fact, but must satisfy themselves by inspection or otherwise as to their accuracy. No person in this firm's employment has the authority to make or give any representation or warranty in respect of the property.

47 South End Road, Hampstead, London, NW3 2QB
Tel: 020 7431 1881 Email: hampstead@salter-rex.co.uk salter-rex.co.uk