



## Leighton Crescent

Kentish Town London NW5 2QY

**£799,500**

An exceptional three bedroom split-level garden apartment, forming part of a landmark modernist building, designed in the late 1970s by renowned architect Edward Cullinan for the Borough of Camden.

Constructed over five floors from stock bricks and overlooking a pretty public garden, the building has a distinctive and pleasing arrangement of metal uprights and balconies to the front.

Offering 1073 square feet (100 square metres) of flexible accommodation, the apartment is presented to a very high standard throughout.

Entered on the upper level, the fabulous dual-aspect open-plan reception of 30' is principally lit from the west by three pairs of glazed double doors, each leading to a separate balcony. The open-plan kitchen is modern, with a range of premium appliances and there is a handy guest WC.

On the garden level, three good double bedrooms, with a thoughtfully-designed range of fitted storage to each, all bedrooms having glazed double doors leading to the garden. A well-appointed modern family bathroom/WC completes the accommodation. Separate, additional private storage is accessed from the basement.

To the rear is a good-sized private garden, mainly paved with shrub borders and a sunny, open westerly aspect. Beyond the private rear garden, there is access to a larger, very well maintained communal garden.

Leighton Crescent is a very attractive residential location, consisting of mainly Victorian terraces set around a leafy public open space. Kentish Town Underground (Northern Line) and Thameslink are within a short walking distance, as are the shops, bars and restaurants of Kentish Town Road.

Outstanding local schools including Torriano Primary and Camden School for Girls are close by.

- Fabulous split-level modern apartment
- Three good double bedrooms
- 30' open-plan reception with three balconies
- Modern kitchen with high-quality appliances
- Well-appointed family bathroom/wc
- Separate guest WC
- Fitted wardrobes to all bedrooms.
- Excellent decorative order
- Excellent example of Modernist architecture by Ted Cullinan
- Good-sized private rear garden, in addition to large, well maintained communal garden.

### Viewing

Please contact our Kentish Town Sales Office on 0207 482 4488 if you wish to arrange a viewing appointment for this property or require further information.



3



1



1





Floor Plan

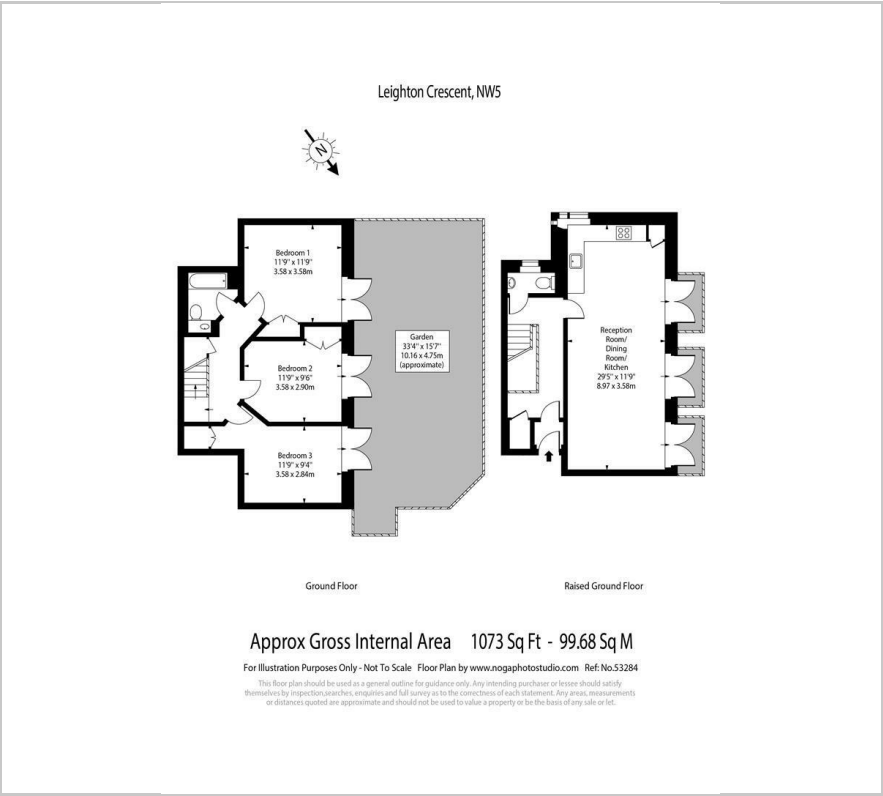

Area Map

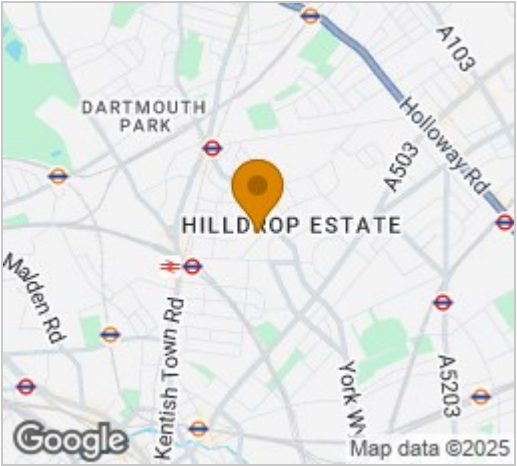

Energy Efficiency Graph



These particulars, whilst believed to be accurate are set out as a general outline only for guidance and do not constitute any part of an offer or contract. Intending purchasers should not rely on them as statements of representation of fact, but must satisfy themselves by inspection or otherwise as to their accuracy. No person in this firm's employment has the authority to make or give any representation or warranty in respect of the property.