



Hampstead Heath, London, NW3 2JB

Asking Price £650,000





# 118 Mansfield Road



## Description

A stunning one bedroom ground floor apartment with sole use of the rear garden, converted from a three storey Victorian terraced house, situated in the highly sought after Mansfield Conservation area.

The property is bright and spacious and has been well maintained by the current owner, and comprises a large sunny reception room with high ceilings and feature fireplace, a good sized double bedroom with fitted wardrobes, family bathroom, and large kitchen/diner leading to the rear garden which extends to approximately 58ft.

Located approximately only seven minutes walk from Hampstead Heath, the property is within easy reach of the shops and cafés in South End Green, as well as the wide range of amenities at nearby Belsize Park, with Gospel Oak and Hampstead Heath Overground Stations, and Belsize Park (Northern Line) tube station providing easy access to the City and West End.

Lease: Approx 89 years remaining

- Ground Floor Flat
- Sunny Reception Room
- Sole Use Of Rear Garden
- Chain Free
- Large Double Bedroom
- Eat-in Kitchen
- Close To Hampstead Heath









Floor Plan

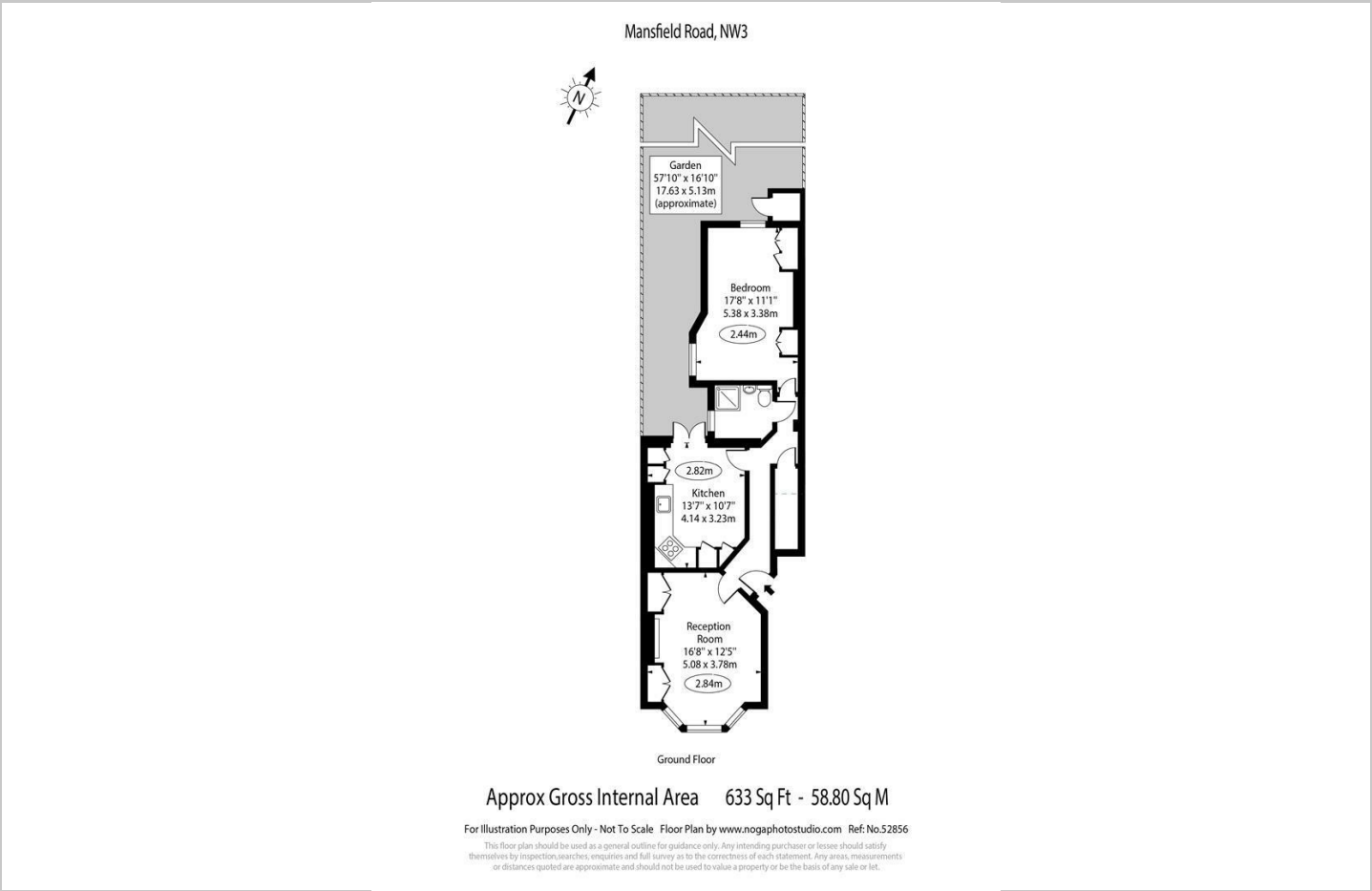

Area Map

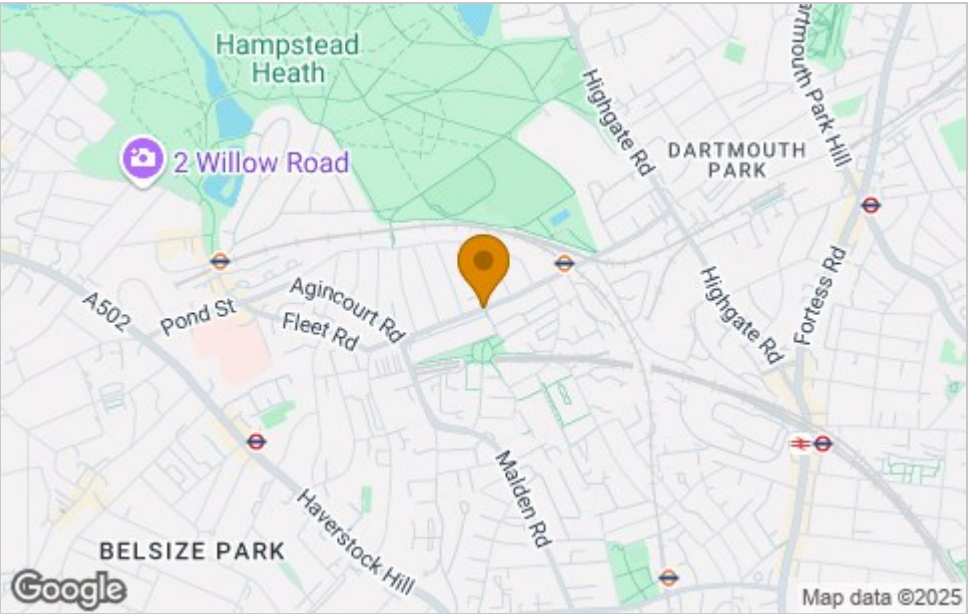

Energy Efficiency Graph

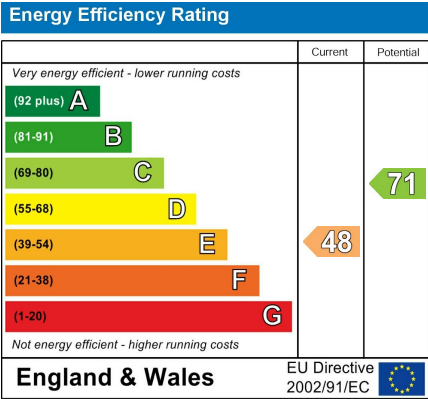

Viewing

Please contact our Hampstead Sales Office on 020 7431 1881 if you wish to arrange a viewing appointment for this property or require further information.

These particulars, whilst believed to be accurate are set out as a general outline only for guidance and do not constitute any part of an offer or contract. Intending purchasers should not rely on them as statements of representation of fact, but must satisfy themselves by inspection or otherwise as to their accuracy. No person in this firms employment has the authority to make or give any representation or warranty in respect of the property.