



Huddleston Road

Kentish Town N7 0EG

£950,000

An exceptionally spacious three storey maisonette arranged over the upper floors of a handsome Victorian Villa, quietly situated in a tranquil residential cul-de-sac, within a very short walk of shops and transport.

Offering a substantial 1147 square feet of accommodation, presented to a good standard, the property benefits from a share of freehold and a very good size terrace, with a pleasant south-easterly aspect directly overlooking Tufnell Park playing fields.

Huddleston Road is a popular tree lined cul-de-sac, ideally placed for very easy access to Tufnell Park underground station (Northern Line) as well as the diverse array of independent retailers, restaurants and of Fortress Road and Campdale Road. Outstanding local schools are nearby.

- Spacious period maisonette
- Three good bedrooms
- Spacious reception room
- Large eat-in kitchen
- Family bathroom/wc
- Large terrace
- Share of Freehold
- Quiet residential location

Viewing

Please contact our Kentish Town Sales Office on 0207 482 4488 if you wish to arrange a viewing appointment for this property or require further information.



Floor Plan

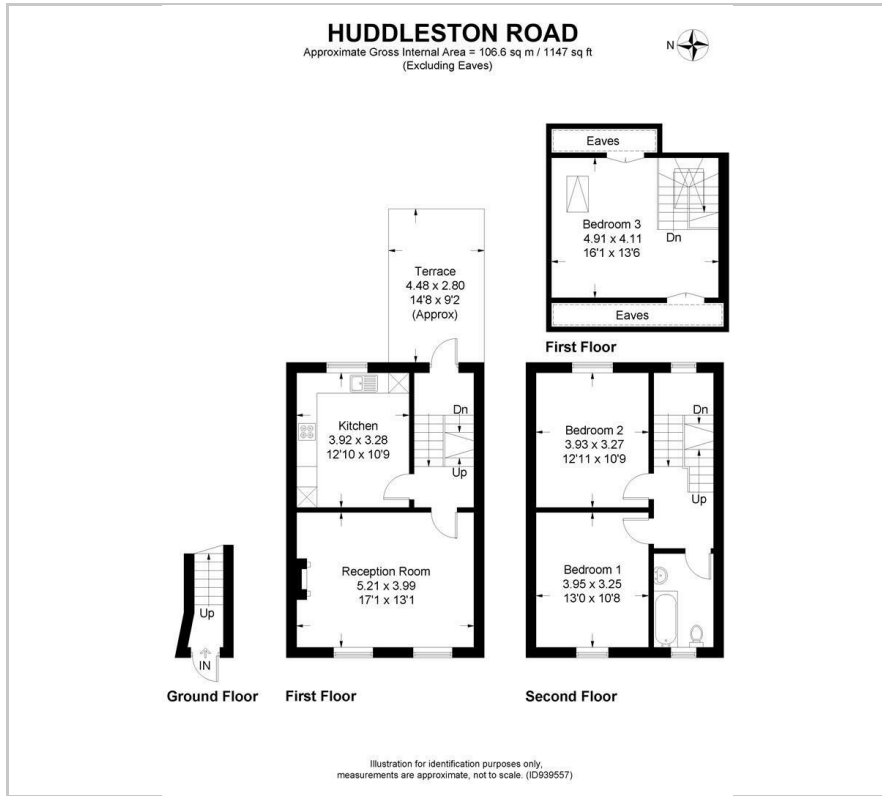

Area Map

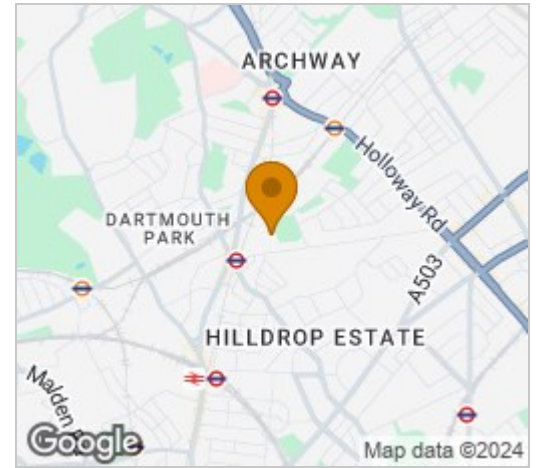

Energy Efficiency Graph

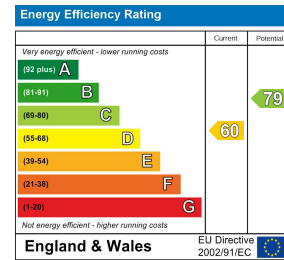

These particulars, whilst believed to be accurate are set out as a general outline only for guidance and do not constitute any part of an offer or contract. Intending purchasers should not rely on them as statements of representation of fact, but must satisfy themselves by inspection or otherwise as to their accuracy. No person in this firm's employment has the authority to make or give any representation or warranty in respect of the property.