



Camden Street

Camden London NW1 0DX

£570,000

A very well presented two bedroom top floor flat, forming part of an attractive period red-brick terrace, conveniently and centrally situated within easy reach of shops and transport.

Offering 700 square feet (65 sq metres) of family friendly accommodation, the property is spacious and conveniently arranged. In particular, the open-plan reception is of a good size, the kitchen has been recently refitted to a high standard and includes a range of quality appliances. Both bedrooms are to the rear of the building and the master bedroom is dual aspect and particularly large.

Camden street is a very convenient residential location, situated just to the east of Camden High St, a short walk from Mornington Crescent (Northern Line) Underground and within very easy reach of the many attractions and amenities of Camden. The Regent's Park is also very close by.

- Top floor period flat
- Two good bedrooms
- Good size open-plan reception
- Recently fitted kitchen with appliances
- Modern bathroom/wc
- Excellent decorative order
- Central location-close to transport
- Leasehold 102 years
- Ground rent £10 PA
- Service charge £999PA

Viewing

Please contact our Kentish Town Sales Office on 0207 482 4488 if you wish to arrange a viewing appointment for this property or require further information.



Floor Plan

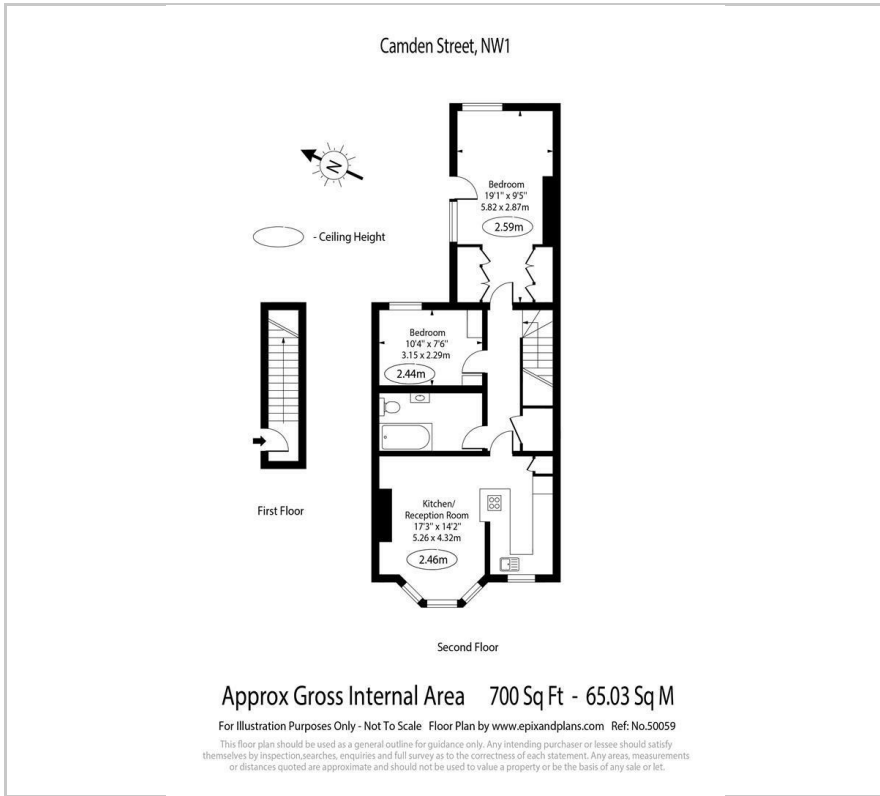

Area Map



Energy Efficiency Graph

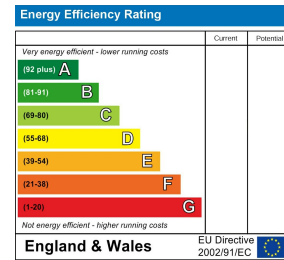

These particulars, whilst believed to be accurate are set out as a general outline only for guidance and do not constitute any part of an offer or contract. Intending purchasers should not rely on them as statements of representation of fact, but must satisfy themselves by inspection or otherwise as to their accuracy. No person in this firm's employment has the authority to make or give any representation or warranty in respect of the property.