



Ash Court

NW5 2QS

Asking Price £350,000

A spacious and well-appointed one-bedroom flat located on the ground floor of a small, three storey purpose-built private development.

Conveniently arranged, the property offers 411 square feet of accommodation and comprises; large reception room, separate modern kitchen, good size bedroom situated to the rear of the building and a combined family bathroom/wc.

The property further benefits from a 993 year lease, communal garden with own storage shed.

Leighton Grove is ideally placed with for easy access to the Overground and Thameslink stations at Kentish Towns and the extensive shops and cafés on Kentish Town Road

Council Tax Band C - £1,592

Lease -992

Share of Freehold

Service charge -£150 per quarter

Ground rent - Nil

- Spacious reception room
- Separate modern kitchen
- Family bathroom
- Good size bedroom
- Small purpose built block
- Communal garden with storage shed
- Council tax band C
- Share of freerhold
- Small block
- Close to Kentish Town Tube Station

Viewing

Please contact our Kentish Town Sales Office on 0207 482 4488 if you wish to arrange a viewing appointment for this property or require further information.



1



1



1



D

Floor Plan

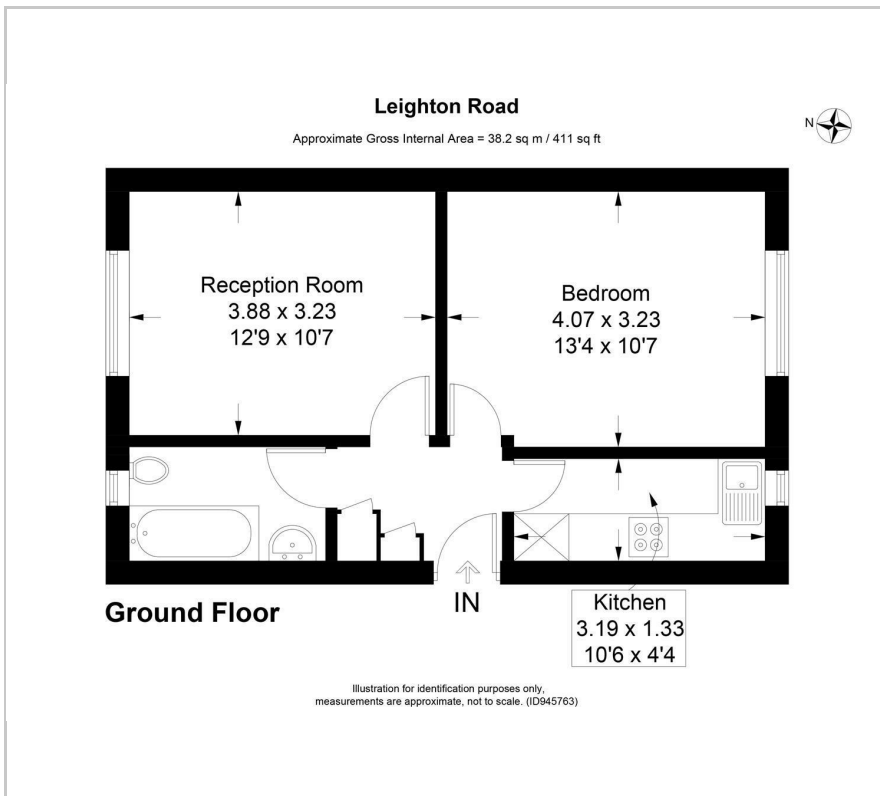

Area Map



Energy Efficiency Graph

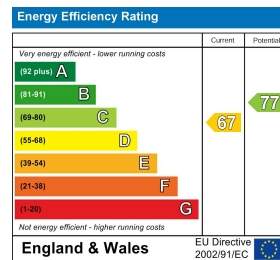

These particulars, whilst believed to be accurate are set out as a general outline only for guidance and do not constitute any part of an offer or contract. Intending purchasers should not rely on them as statements of representation of fact, but must satisfy themselves by inspection or otherwise as to their accuracy. No person in this firm's employment has the authority to make or give any representation or warranty in respect of the property.