



Trecastle Way

Tufnell Park London N7 0EL

£995,000

An exceptional three storey terraced house, forming part of a most attractive crescent, constructed in the 1970s in the contemporary Modernist manner and situated very conveniently for local amenities.

Offering 1182 square feet (110 Sq metres) of family-friendly accommodation, refurbished to a high standard throughout, the property has been substantially extended on the ground floor to create a delightfully spacious, bright and modern reception space, flooded with natural light and with the benefit of under floor heating. The kitchen has recently been refitted to a very high standard and there is a handy ground floor guest WC

On the upper two floors, all the bedrooms are of a good size, three fitted with extensive wardrobe space, the other currently being used as a reception. The family bathroom/WC has been recently refurbished.

To the rear is a good size low-maintenance patio garden.

Trecastle Way is a quiet residential side turning, situated in leafy Tufnell Park, within easy reach of the shops, bars, restaurants and outstanding local Schools of Tufnell Park and Kentish Town. Residents of Trecastle Way have access to a locked communal garden with a play area for children and facilities for growing produce, for which there is a cost of £619PA

- Modernist terraced house
- Four good bedrooms
- Extended open-plan reception
- Recently refitted kitchen
- Modern family bathroom/wc
- Ground floor guest wc
- Under floor heating
- Fitted wardrobes
- Low-maintenance patio garden
- Tranquil location

Viewing

Please contact our Kentish Town Sales Office on 0207 482 4488 if you wish to arrange a viewing appointment for this property or require further information.



4



2



1



Floor Plan

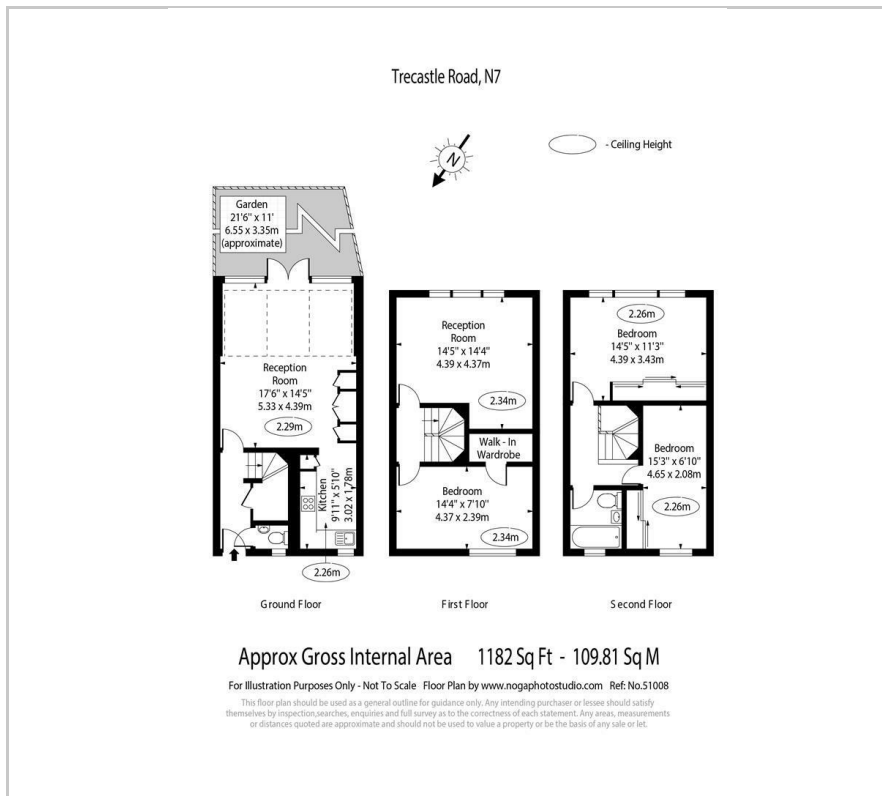

Area Map

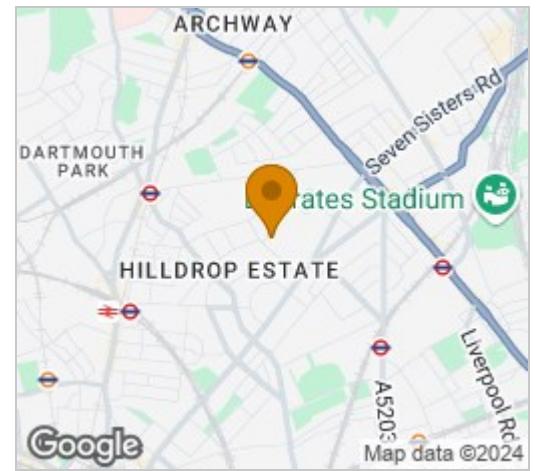

Energy Efficiency Graph

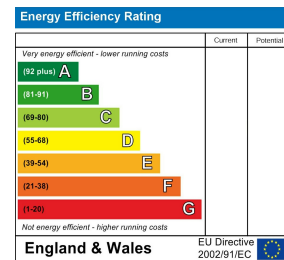

These particulars, whilst believed to be accurate are set out as a general outline only for guidance and do not constitute any part of an offer or contract. Intending purchasers should not rely on them as statements of representation of fact, but must satisfy themselves by inspection or otherwise as to their accuracy. No person in this firm's employment has the authority to make or give any representation or warranty in respect of the property.