



16A Gordon House Road

Gospel Oak, London, NW5 1LN

£860,000

An exceptionally fine two bedroom garden maisonette occupying the lower two floors of an attractive period terrace, ideally situated within a very short distance of Hampstead Heath.

Offering 935 square feet of very conveniently arranged and well presented accommodation, the property is flooded with natural light, the rear facing due south. In particular the open-plan reception is wonderfully bright and spacious, retaining a great deal of period charm and detail including the original fireplace and decorative plasterwork. The modern kitchen is fitted with a range of integrated appliances and there is a handy guest wc on the upper level.

On the lower ground floor are two very good double bedrooms with excellent storage and a family bathroom/wc.

To the rear is a good size private garden with a delightfully verdant south-facing garden.

Gordon House Road is a very convenient residential location in the heart of Gospel Oak. The open spaces of Hampstead Heath are moments away as is Gospel Oak Underground. The nearest Underground station is at Kentish Town, within easy walking distance.

- Exceptional garden maisonette
- Two very good double bedrooms
- Large open-plan reception with period features
- Well-appointed fitted kitchen
- Family bathroom/wc
- Further guest wc
- Excellent layout
- Close to Heath
- South-facing garden
- Leasehold 952 years

Viewing

Please contact our Kentish Town Sales Office on 0207 482 4488 if you wish to arrange a viewing appointment for this property or require further information.



2



1



1



C

Floor Plan

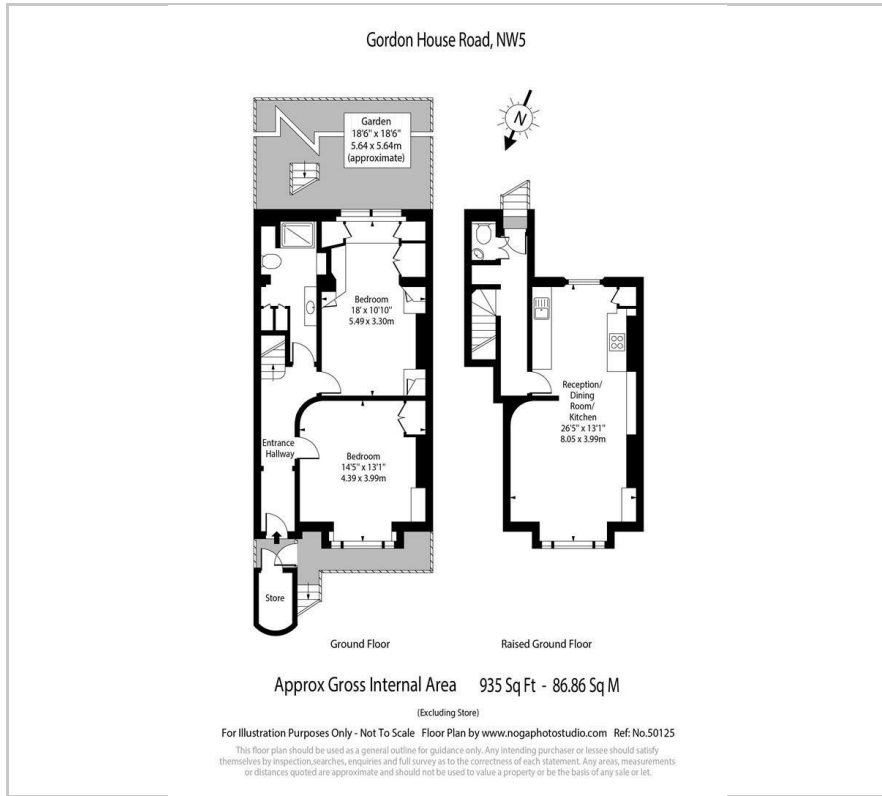

Area Map



Energy Efficiency Graph

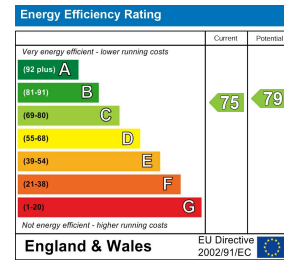

These particulars, whilst believed to be accurate are set out as a general outline only for guidance and do not constitute any part of an offer or contract. Intending purchasers should not rely on them as statements of representation of fact, but must satisfy themselves by inspection or otherwise as to their accuracy. No person in this firm's employment has the authority to make or give any representation or warranty in respect of the property.